

Android enterprise

Work-Managed enrolment
QR code provisioning



AirWatch



Android 7.x

September 2017

Enterprise Mobility documentation by baytoun



Requirements

In order to proceed, you must have:

- Android 7.0 or later installed on the devices to be provisioned. Earlier Android versions are incompatible.
- OEM support for QR code provisioning.
- A functional AirWatch EMM solution in place.
- Android enterprise fully configured on your EMM platform.

QR provisioning is the newest form of manual Android enterprise Work-Managed enrolment and is not widely supported. Consider as an alternative NFC enrolment or DPC identifier enrolment.





Configure the QR code

Before Android enterprise QR enrolment can occur, you must generate a QR Code unique and up to date with your environment and the latest AirWatch DPC APK.

Vendor documentation for QR code generation can be found here:

[https://my.air-watch.com/help/9.1/en/Content/Platform_Guides/Android Work/C/Enrollment Overview.htm](https://my.air-watch.com/help/9.1/en/Content/Platform_Guides/Android_Work/C/Enrollment_Overview.htm)





Initiate the QR reader

Hidden on the Welcome screen of many* Android 7.0+ devices is the QR reader initiation process.

The simplest way of knowing if the device supports QR provisioning is by tapping on **Welcome** 6 times in quick succession.

*Not all OEMs support QR code enrolment, be sure to validate this before attempting provisioning.

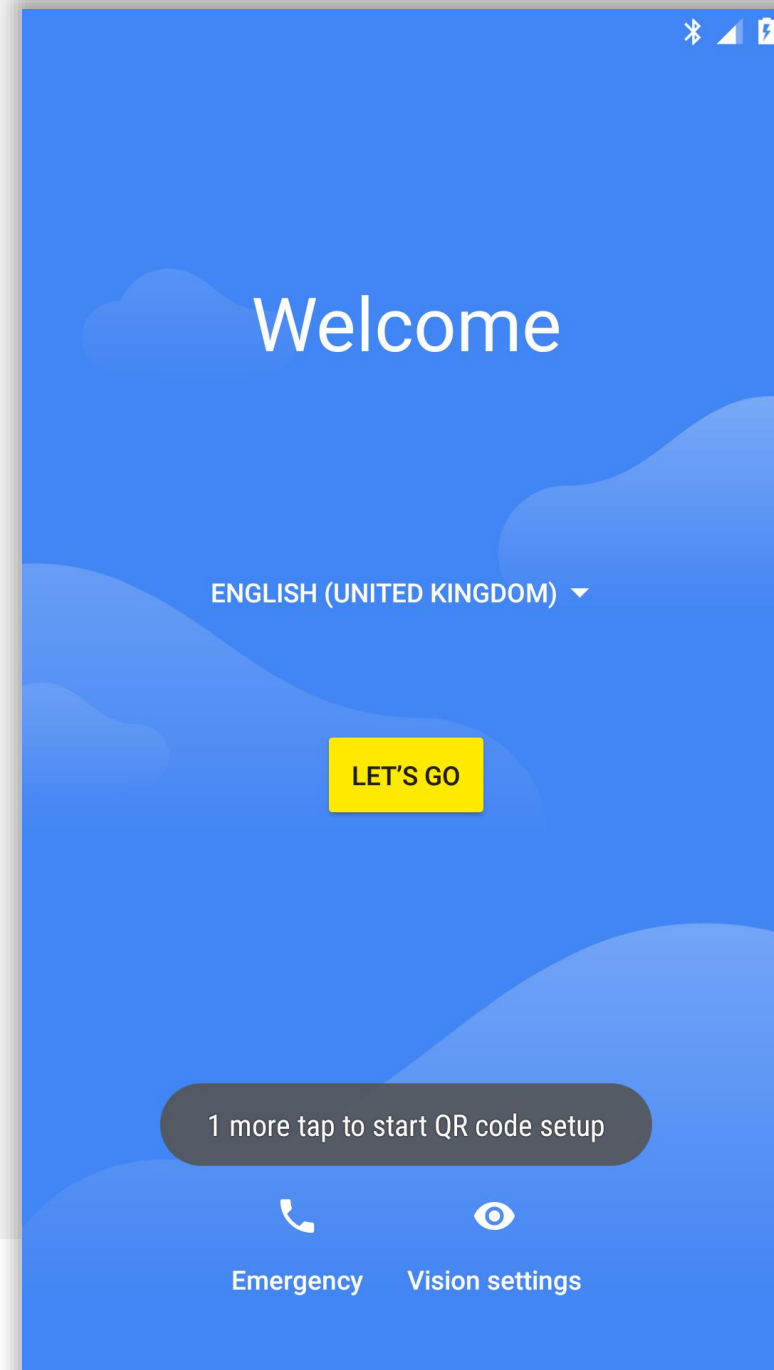



Initiate the QR reader

Once the QR process has successfully initiated, QR code setup will display.

Tap **NEXT** to continue.

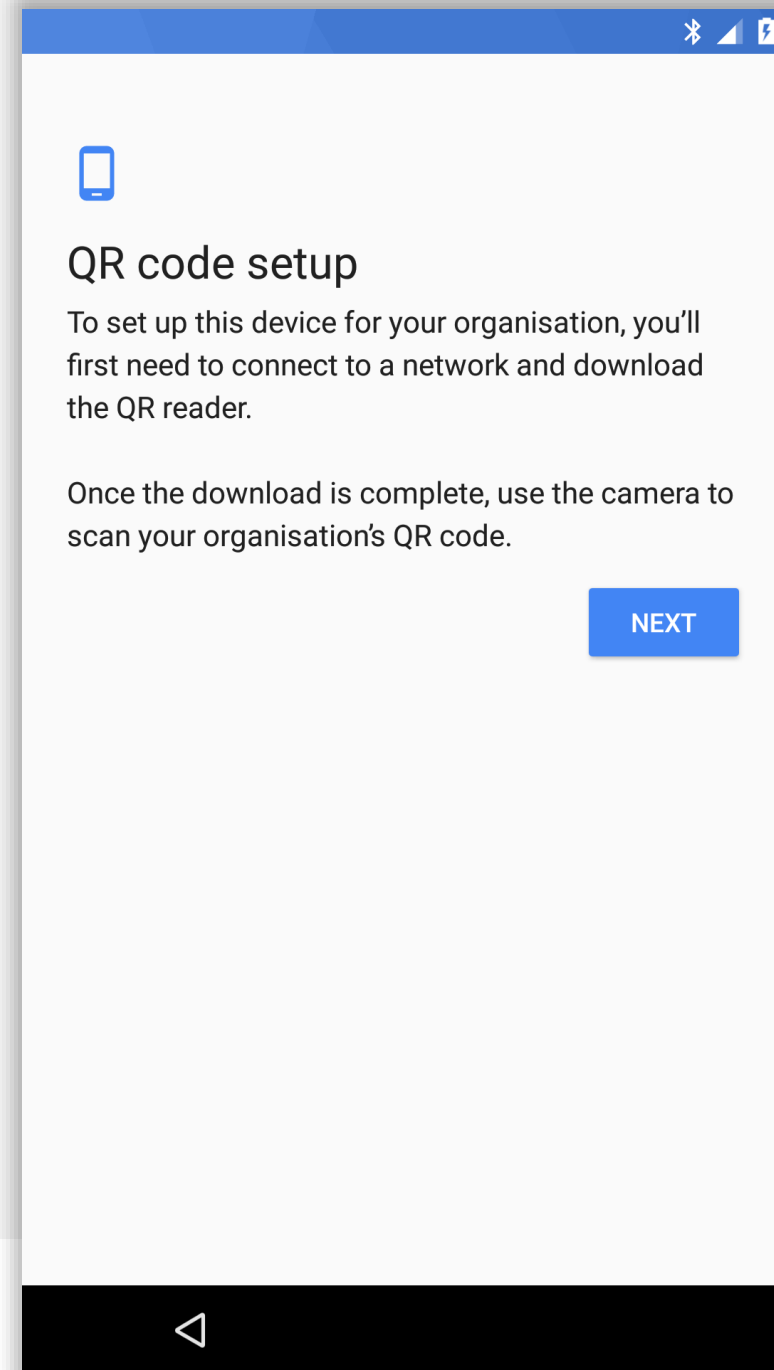



Initiate the QR reader

You will be prompted to connect to WiFi in order to continue the provisioning process.

Tap an SSID and authenticate to continue.

Alternatively, for devices with an active data connection, WiFi can be skipped by selecting **Use mobile network for setup**.

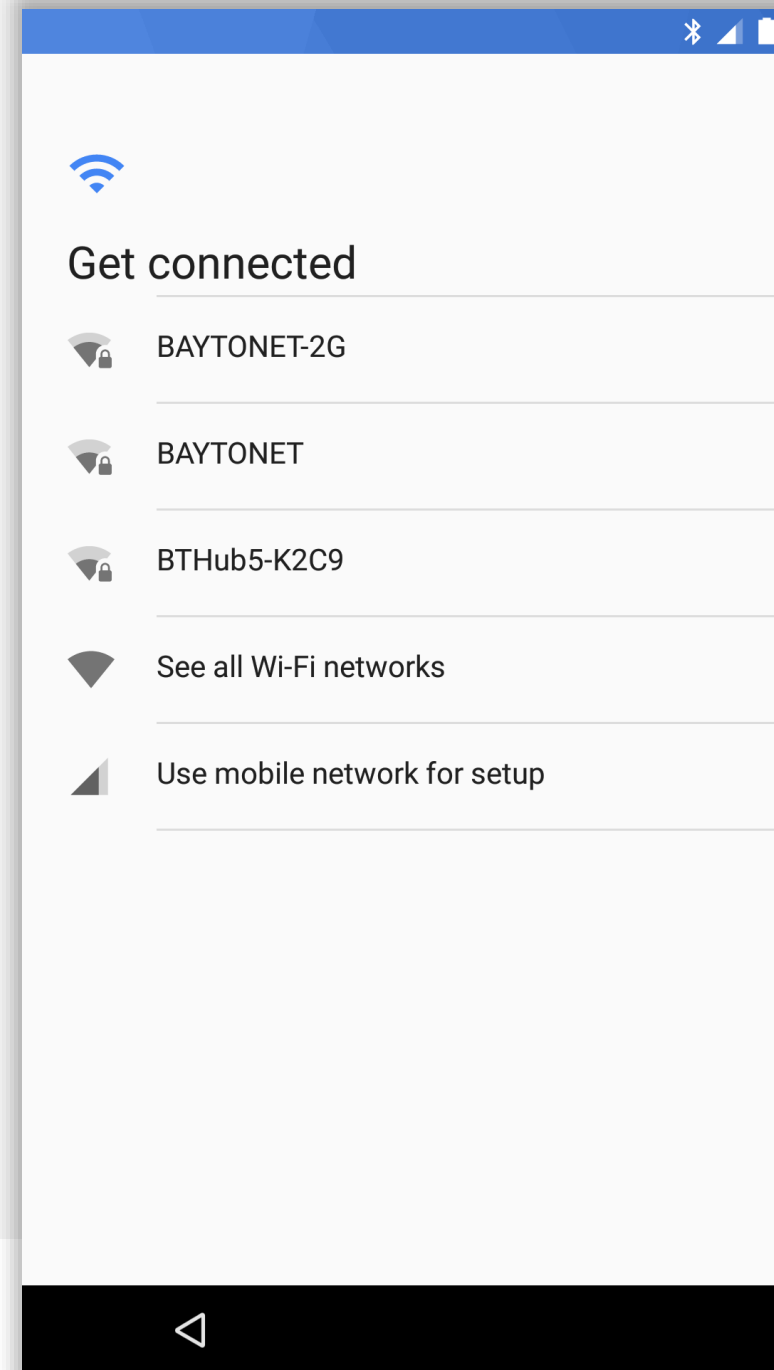



Initiate the QR reader

The device will check for updates, install the QR reader and continue automatically.

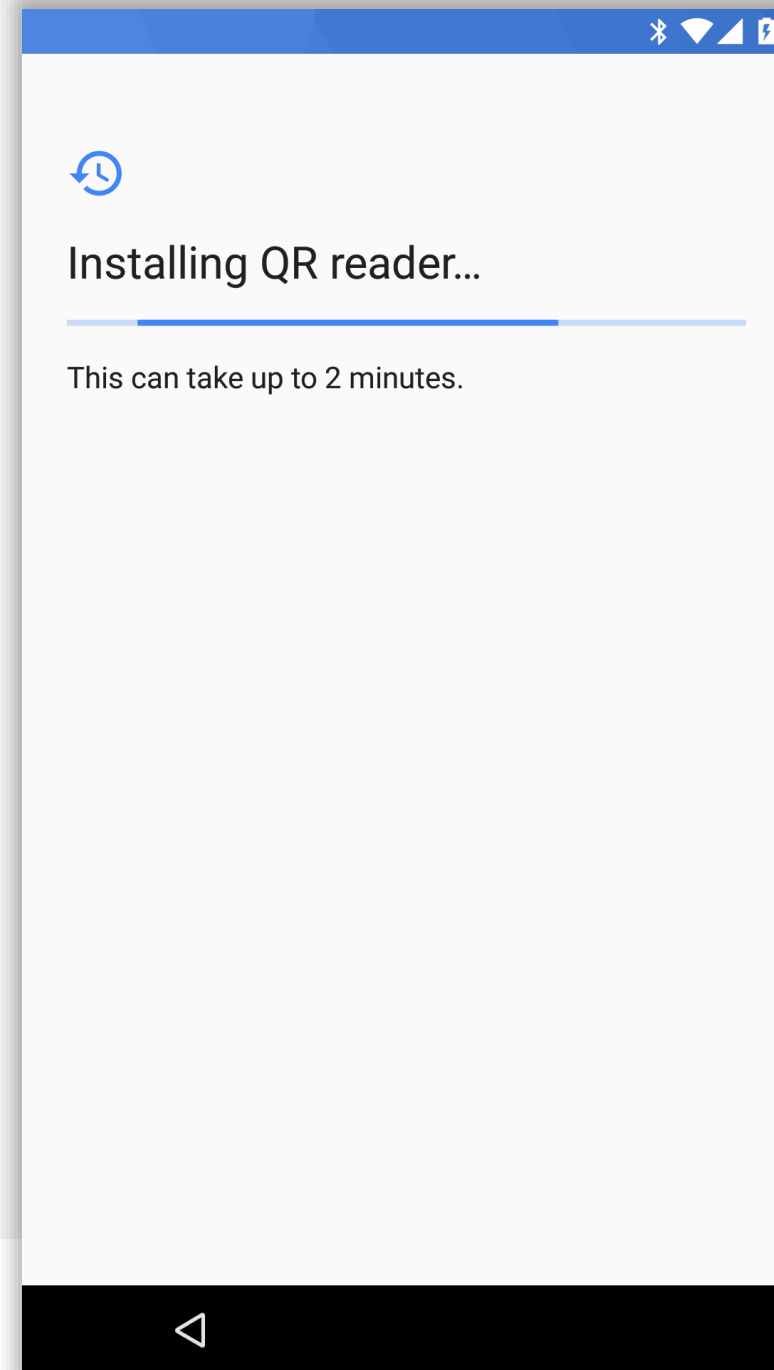



Scan the QR code

Once installed successfully, the QR reader will automatically launch.

At this point, locate the QR code using the device camera. Both front and rear-facing cameras may be used.

Note:

If the QR code is not valid, the device will fail to provision and may request a factory reset. This is a time-consuming process so do ensure the QR code being scanned is valid.





Begin provisioning

Once the QR payload has been transmitted, the device being provisioned will display a prompt with an overview of monitoring capabilities.

You must accept the device being managed by the organisation in order to begin provisioning.

Tap **OK** to proceed.

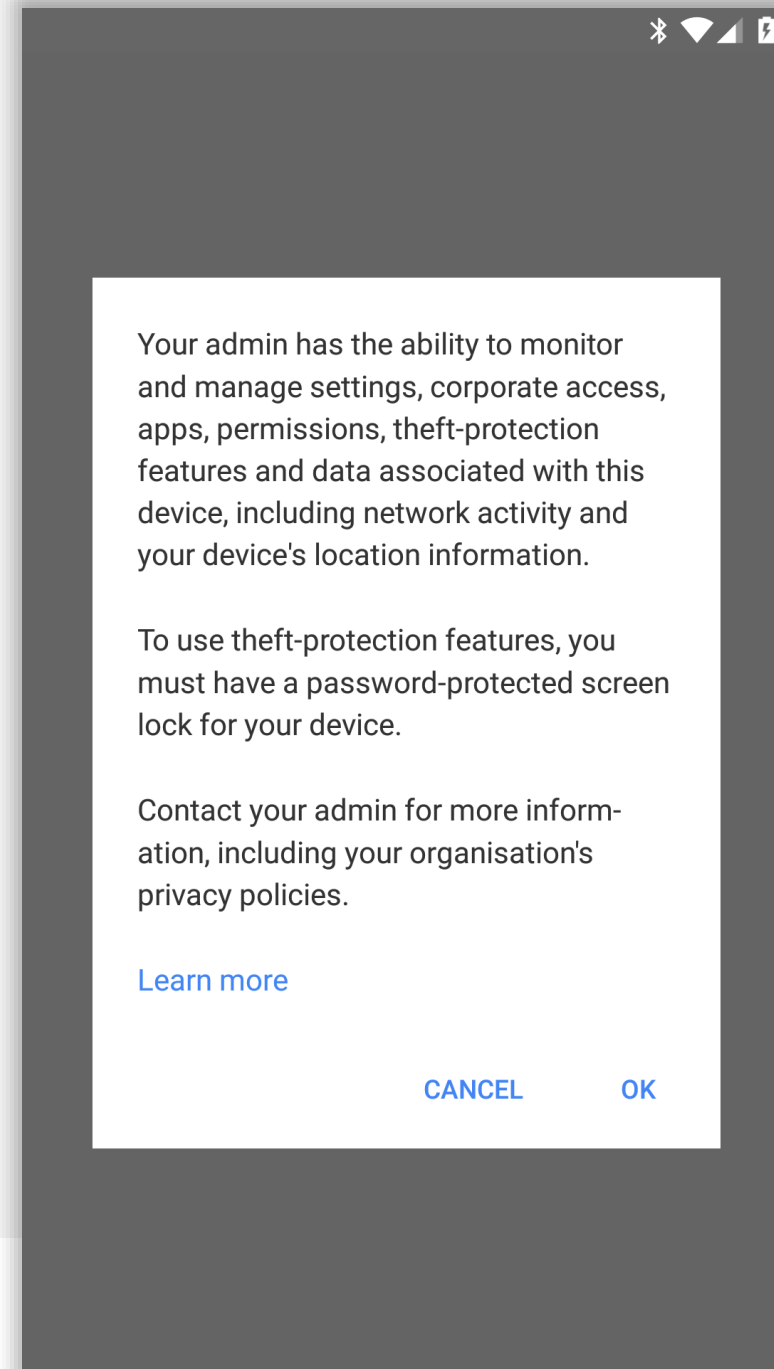



The device will provision

The device will attempt to download the DPC provided in the QR payload, install it and set AirWatch as the device owner.

This may take a few minutes.

The following prompts may include license acceptance, agreement to services or finishing the setup Wizard. This varies between OEMs, however when complete the device will display a sparse home screen before the DPC launches.

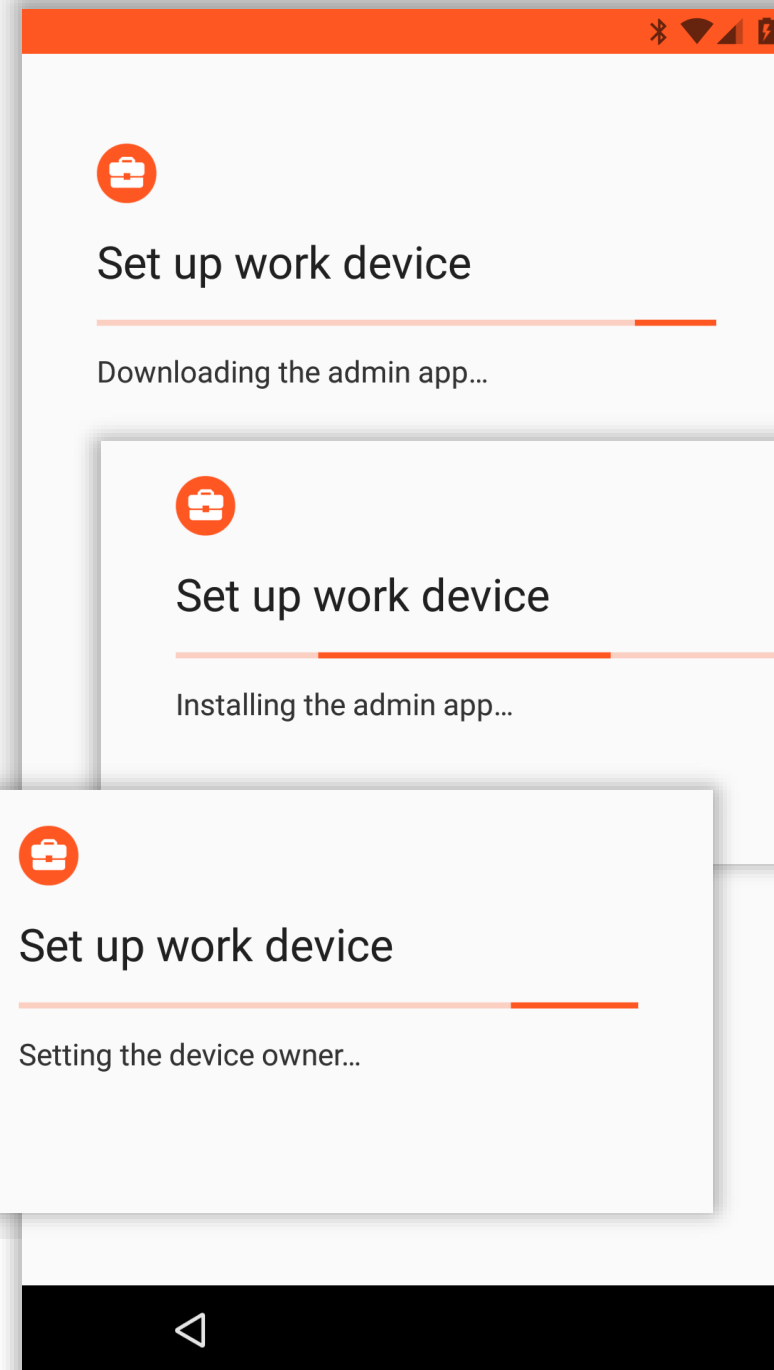



Begin enrolment

Shortly after Android enterprise provisioning is complete, the DPC will automatically launch and begin enrolment (there is no need to manually open the DPC from the home screen).

This is based on the AirWatch QR documentation which supports auto-enrolment credentials embedded within the QR code. If this data is not supplied, AirWatch will prompt for enrolment credentials.

For Admins:

If using credentials, it would be more secure to do so in conjunction with AirWatch device staging, allowing a user to login from the agent rather than populating the QR code with user credentials.

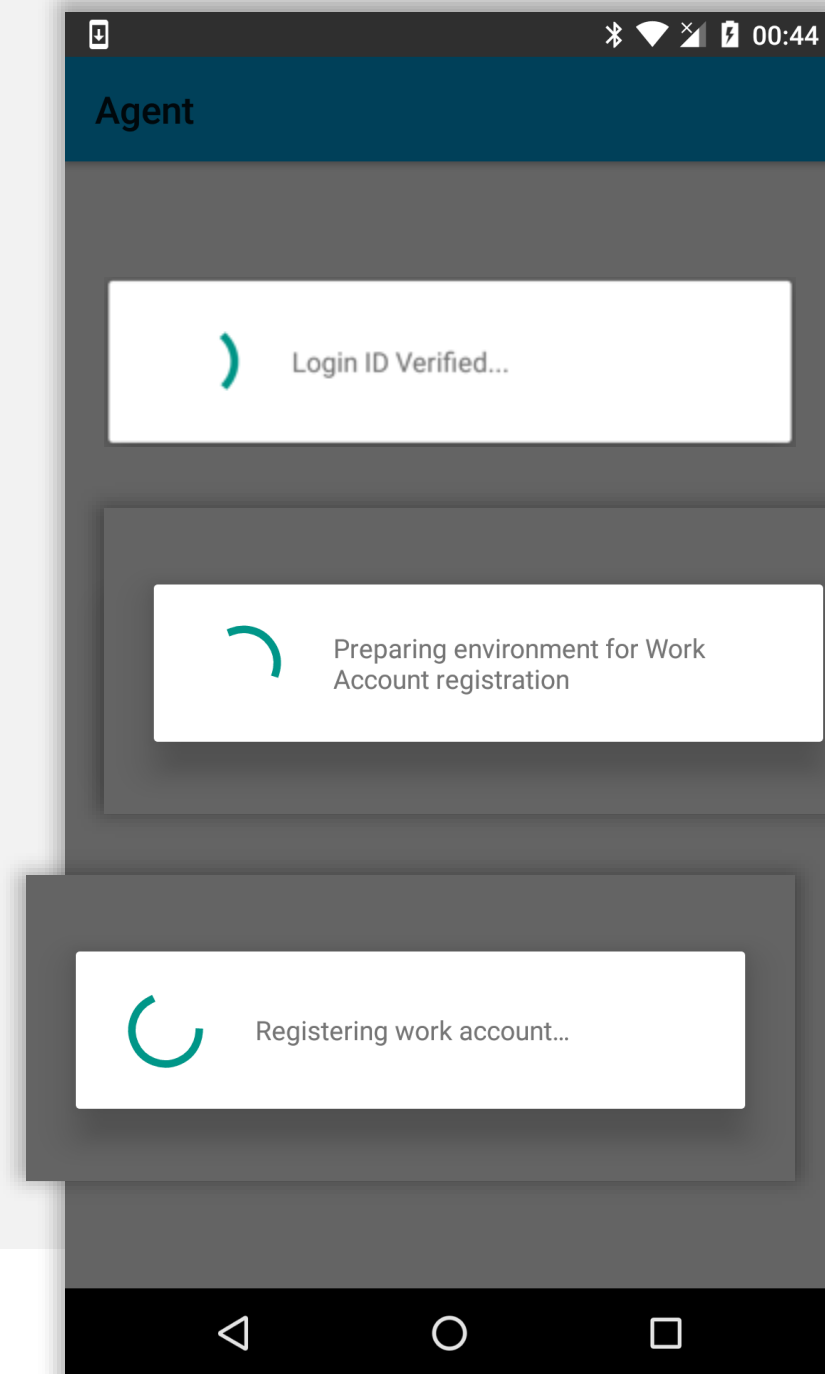



Enrolment complete

The device has now completed enrolment and will continue to pull down applications and resources in the background if configured.

You may tap the home (O) button to leave the DPC.

If a passcode policy has been configured, you will be prompted to set one up shortly.

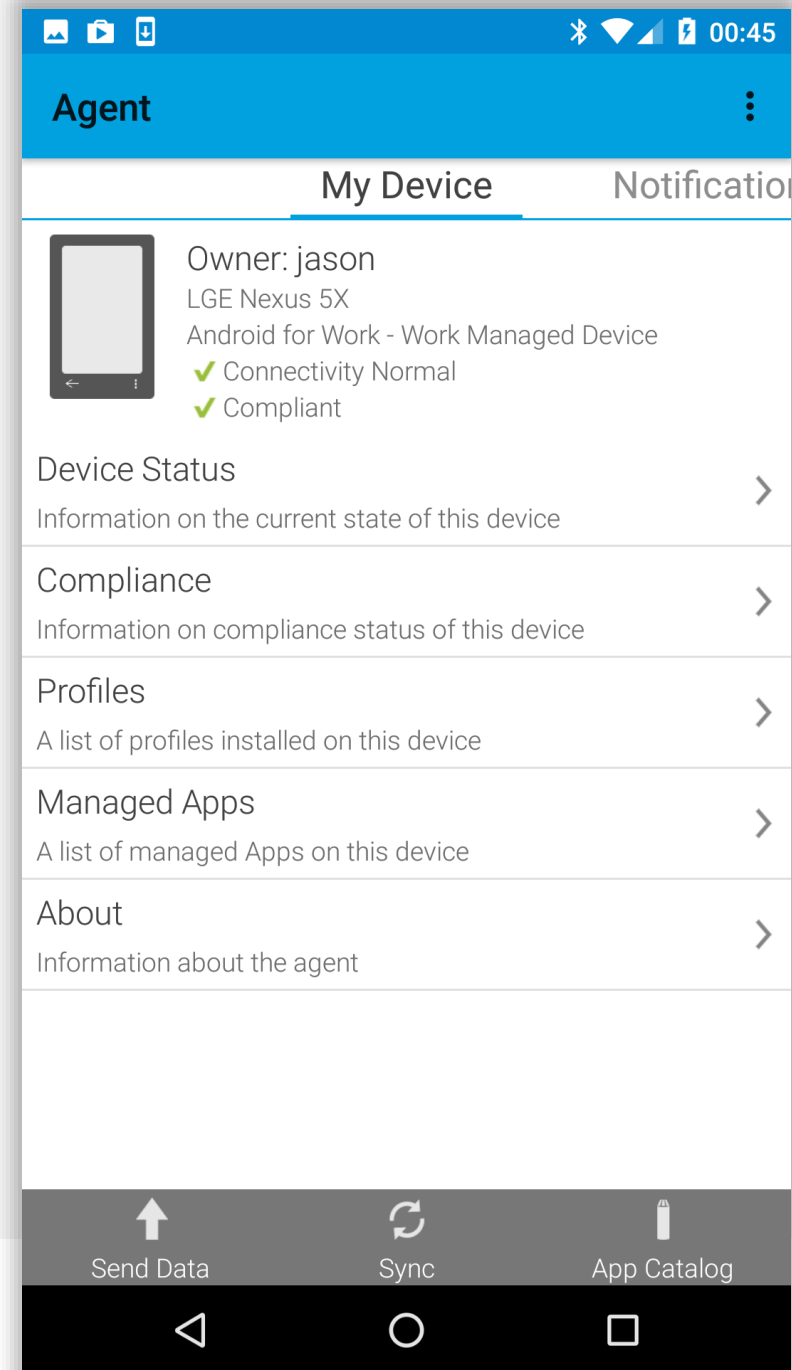

bayton



Jason Bayton



bayton.org



/in/jasonbayton



@jasonbayton



+JasonBaytonX



jason@bayton.org

Updates to this document can be found here:

[Android enterprise provisioning guides](#)

